

CHRONOS





EXTERNAL USE





ONLY POWER



EASY TO INSTALL



ANTI-VANDAL

Product	Code	Power supply V	Power W	Color	Number of lights	Brightness Lm	Working temperatures C°	Number of LEDs	ø Lens mm	Protection IP	Weight Kg	Pallet
1 LIGHT 	CHR1LG	24V ac/dc	2W	●	1	122Lm	-20 +55°	18	120	66	1.54	72
	CHR1LR			●								
	CHR1LV	230V ac	5W	●								
2 LIGHTS 	CHR2LRV	24V ac/dc	2W	● ●	2	122Lm	-20 +55°	18	120	66	2.40	48
		230V ac	5W									
3 LIGHTS 	CHR3LRGV	24V ac/dc	2W	● ● ●	3	122Lm	-20 +55°	18	120	66	3.28	36
		230V ac	5W									

**PALLET
DIMENSIONS**

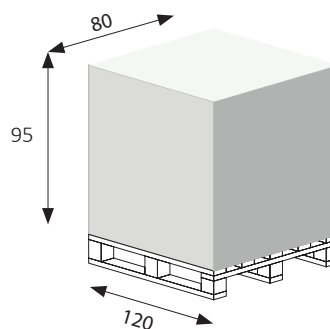

DIMENSIONS AND SIZE

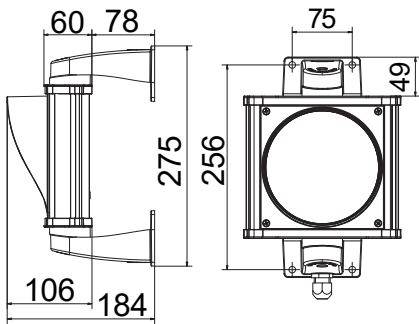

TRAFFIC LIGHT WITH 1 LIGHT

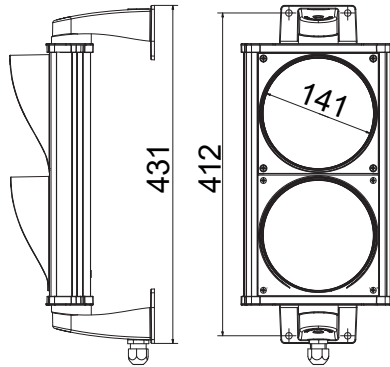

TRAFFIC LIGHT WITH 2 LIGHTS

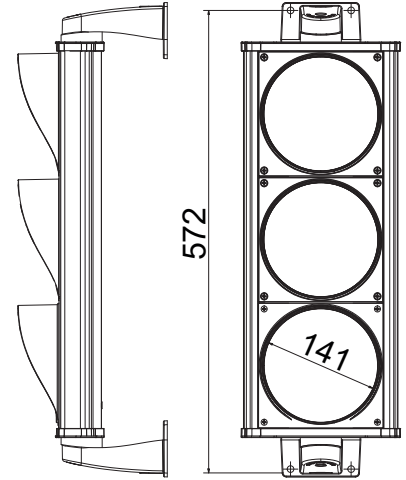

TRAFFIC LIGHT WITH 2 LIGHTS

FIELDS OF APPLICATION



PRIVATE



LOGISTICS

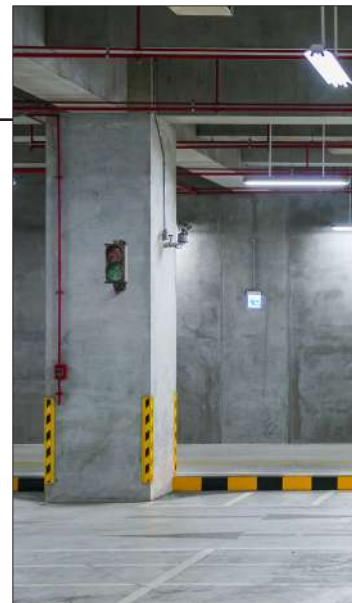

PARKING AREA

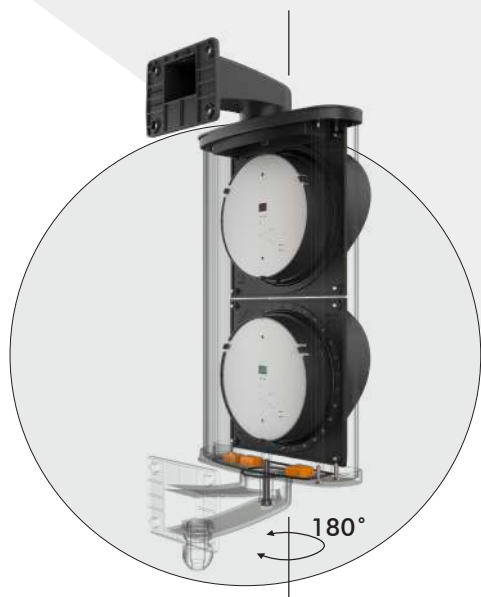

180 ° ROTATABLE AND HIDDEN CABLE PASSAGE IN THE BRACKET FOR MAXIMUM SAFETY.



TRAFFIC LIGHT
CHRONOS

PARTICULAR
INDIVIDUAL COMPONENTS

Consisting of an aluminum profile, powder coated with reinforcements internal, technopolymer covers, for a rigidity and resistance unsurpassed mechanics. Lens e sun visor, a single piece that is water-proof and leakproof.



A multivoltage traffic light, easy to wire as it automatically detects the incoming voltage (from 24 to 230V), 18 LEDs per lamp for optimal brightness, possibility of disassembling the electronics from the front, for both repairs and maintenance.

ACCESSORIES



CHRMS

Short bracket kit 55mm for Chronos.



AMPS

Pair of brackets for attaching the traffic light to the pole.



APS

Galvanized pole (Ø 60mm) for traffic light support, length 3m.